

NXPTZCW

CORNER MOUNT ADAPTOR



DESCRIPTION

Thick AISI 316L stainless steel corner adapter module. Suitable for NXPTZWB bracket.

TECHNICAL DATA

MECHANICAL

Made of AISI 316L electropolished stainless steel
Load rating: 50kg (110lb)
Dimensions: 335x186mm (13.2x7.3in)
Unit weight: 3.6kg (7.9lb)

PART NUMBER

NXPTZCW AISI 316L stainless steel corner adapter module

PACKAGE

Model Number	Weight	Dimensions (WxHxL)	Master carton
NXPTZCW	4.8kg (10.6lb)	36.5x25.5x26cm (14.4x10x10.2in)	5

TECHNICAL DRAWINGS

The indicated measurements are expressed in millimetres.

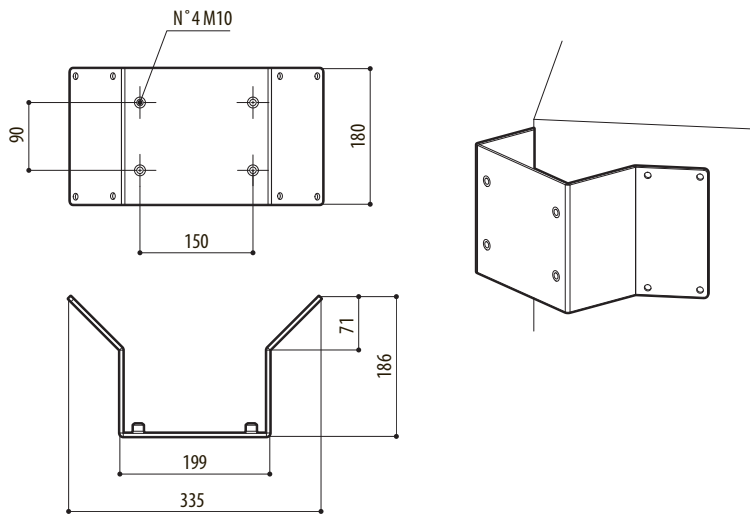

NXPTZCW