

NXPTZ RANGE, ACCESSORIES



CMS-CMA

ARMoured AND UNARMoured MULTI-POLAR CABLES SOLD BY THE METRE

Prepared for Ethernet, video, I/O and telemetry connections

Resistant to oil, flames and ultra-violet rays

Available in an armoured and unarmoured version

Available in black or blue

Designed for potentially explosive zones



CMS-CMA

WAS-WASPT

5 OR 23 LITER TANK WITH PUMP

Polyethylene tank with stainless steel cage

Versions with delivery up to 5m (16ft), 11m (36ft) or 30m (98ft)

Operating temperature: from -10°C (14°F) up to +60°C (140°F)

Available voltages in 230Vac, 120Vac or 24Vac

IP protection degree: IP66 (only products with 5m or 11m delivery head)

The WASPT0V23L11M00 washer pump with tank of 23l (6gal) and delivery head 11m (36ft) is certified "Lloyd's Register Marine Type Approval"



WASHERS AND TANKS

WASNX

WASHER PUMP WITH SOLENOID VALVE FOR STAINLESS STEEL PRODUCTS

Enclosure made of stainless steel AISI 316L

Delivery head: up to 20m (66ft)

Water tank capacity: 10l (2.6gal)

Suitable for Videotec products or with third-party products

Operating temperature: from -20°C (-4°F) up to +60°C (140°F)

Available voltages: 230Vac, 120Vac, 24Vac



WASNX

FM1010

EMC FILTER FOR MARINE CERTIFICATION

Electrical data: from 0 up to 250V DC/AC 50/60 Hz, 6A



FM1010

TECHNICAL DATA

CMS-CMA

CMSN2200

GENERAL

Unarmoured black cable: 2 Ethernet cables, 3 power supply conductors, 2 coaxial video cables, 15 alarm conductors, relay and telemetry

MECHANICAL

Unarmoured cable

External diameter: 18.6mm (0.7in) \pm 0.35mm

Minimum bending radius: 186mm

Colour: Black (RAL9005)

ELECTRICAL

Power supply

- Number of conductors (electrical): 3
- Section: 1.5mm²
- Working voltage: 300V max

NETWORK

Ethernet: 2 cables, Category 5E, shielded cables

VIDEO

2 coaxial cables, RG179

I/O INTERFACE

Alarms, relay and telemetry

- Number of conductors (electrical): 15
- Section: 0.34mm²

ENVIRONMENT

Temperature: from -40°C (-40°F) up to +85°C (+185°F)

Type of laying: fixed installation

Oil resistant (complies with CNOMO E.03.40.150N, ASTM n.2, IRM 902, IEC60811-2-1)

UV resistant (complies with UL1581)

Flame resistant (complies with IEC/EN 60332-1)

CERTIFICATIONS

UL Style 20233

COMPLIANCE

IEC/EN 60079-14 (ATEX Ex II)

CMSB2200

GENERAL

Unarmoured blue cable: 2 Ethernet cables, 3 power supply conductors, 2 coaxial video cables, 15 alarm conductors, relay and telemetry

MECHANICAL

Unarmoured cable

External diameter: 18.6mm (0.7in) \pm 0.35mm

Minimum bending radius: 186mm

Colour: Blue (RAL5015)

ELECTRICAL

Power supply

- Number of conductors (electrical): 3
- Section: 1.5mm²
- Working voltage: 300V max

NETWORK

Ethernet: 2 cables, Category 5E, shielded cables

VIDEO

2 coaxial cables, RG179

I/O INTERFACE

Alarms, relay and telemetry

- Number of conductors (electrical): 15
- Section: 0.34mm²

ENVIRONMENT

Temperature: from -40°C (-40°F) up to +85°C (+185°F)

Type of laying: fixed installation

Oil resistant (complies with CNOMO E.03.40.150N, ASTM n.2, IRM 902, IEC60811-2-1)

UV resistant (complies with UL1581)

Flame resistant (complies with IEC/EN 60332-1)

CERTIFICATIONS

UL Style 20233

COMPLIANCE

IEC/EN 60079-14 (ATEX Ex II)

CMAN1200

GENERAL

Armoured black cable: 1 Ethernet cable, 3 power supply conductors, 1 coaxial video cable, 7 alarm conductors, relay and telemetry

MECHANICAL

Armoured cable

External diameter: 20.0mm (0.78in) ± 0.5mm (0.02in)

Minimum bending radius: 220mm

Colour: Black (RAL9005)

ELECTRICAL

Power supply

- Number of conductors (electrical): 3
- Section: 2.5mm²
- Working voltage: 300V max

NETWORK

Ethernet: 1 cable, Category 5E, shielded cable

VIDEO

1 coaxial cable, RG179

I/O INTERFACE

Alarms, relay and telemetry

- Number of conductors (electrical): 7
- Section: 0.34mm²

ENVIRONMENT

Temperature: from -60°C (-76°F) up to +105°C (+221°F)

Type of laying: fixed installation

Oil resistant (complies with CNOMO E.03.40.150N, ASTM n.2, IRM 902, VDE 0472 p.803 test B)

UV resistant (complies with IEC 60068-2-5)

Flame resistant (complies with IEC/EN 60332-1, IEC/EN 60332-3-22)

COMPLIANCE

IEC/EN 60079-14 (ATEX Ex II)

CMAB1200

GENERAL

Armoured blue cable: 1 Ethernet cable, 3 power supply conductors, 1 coaxial video cable, 7 alarm conductors, relay and telemetry

MECHANICAL

Armoured cable

External diameter: 18.0mm (0,7in) ± 0.5mm (0.02in)

Minimum bending radius: 230mm (9.0in)

Colour: Blue (RAL5015)

ELECTRICAL

Power supply

- Number of conductors (electrical): 3
- Section: 1.5mm²
- Working voltage: 300V max

NETWORK

Ethernet: 1 cable, Category 5E, shielded cable

VIDEO

1 coaxial cable, RG179

I/O INTERFACE

Alarms, relay and telemetry

- Number of conductors (electrical): 7
- Section: 0.34mm²

ENVIRONMENT

Temperature: from -60°C (-76°F) up to +105°C (+221°F)

Type of laying: fixed installation

Oil resistant (complies with CNOMO E.03.40.150N, ASTM n.2, IRM 902, VDE 0472 p.803 test B)

UV resistant (complies with IEC 60068-2-5)

Flame resistant (complies with IEC/EN 60332-1, IEC/EN 60332-3-22)

COMPLIANCE

IEC/EN 60079-14 (ATEX Ex II)

PART NUMBER

CMAB1200	Armoured blue cable
CMAN1200	Armoured black cable
CMSB2200	Unarmoured blue cable
CMSN2200	Unarmoured black cable

WAS-WASPT

Washer pump, tank of 5l (1.3gal), 5m (16ft) delivery

Polyethylene tank, stainless steel cage

Dimensions (WxHxL): 217x272x257mm (8.5x10.7x10.1in)

Cable glands: 1xM20 + 3xM16

Unit weight: 3.5kg (7.7lb) (WAS), 3.8kg (8.4lb) (WASPT)

Water tank capacity: 5l (1.3gal)

Delivery head: 5m (16ft) max

Tube length: 5m (16ft)

Supply voltage/Current consumption:

- 230Vac, 0.3A, 50/60Hz
- 120Vac, 0.6A, 50/60Hz
- 24Vac, 1.8A, 50/60Hz

Operating temperature

- Maximum temperature: 60°C (140°F)
- Minimum temperature with antifreeze liquid in solution: -10°C (14°F)
- Minimum temperature with antifreeze liquid in solution (reduced performance and delivery height): -25°C (-13°F)

Electrical safety (CE): EN60950-1

Electromagnetic compatibility (CE): EN50130-4, EN61000-6-3, EN55032 (Class B), FCC Part 15 (Class B)

Outdoor installation (CE): EN60950-22

IP protection degree (EN60529):

- IP66

EAC certification

Washer pump, tank of 23l (6gal), 5m (16ft) delivery

Polyethylene tank, stainless steel cage

Dimensions (WxHxL): 301x410x348mm (11.8x16.1x13.7in)

Cable glands: 1xM20 + 3xM16

Unit weight: 5.4kg (11.9lb) (WAS), 5.5kg (12.1lb) (WASPT)

Water tank capacity: 23l (6gal)

Delivery head: 5m (16ft) max

Tube length: 5m (16ft)

Supply voltage/Current consumption:

- 230Vac, 0.3A, 50/60Hz
- 120Vac, 0.6A, 50/60Hz
- 24Vac, 1.8A, 50/60Hz

Operating temperature

- Maximum temperature: 60°C (140°F)
- Minimum temperature with antifreeze liquid in solution: -10°C (14°F)
- Minimum temperature with antifreeze liquid in solution (reduced performance and delivery height): -25°C (-13°F)

Electrical safety (CE): EN60950-1

Electromagnetic compatibility (CE): EN50130-4, EN61000-6-3, EN55032 (Class B), FCC Part 15 (Class B)

Outdoor installation (CE): EN60950-22

IP protection degree (EN60529):

- IP66

EAC certification

Washer pump, tank of 23l (6gal), 11m (36ft) delivery

Polyethylene tank, stainless steel cage

Dimensions (WxHxL): 301x410x348mm (11.8x16.1x13.7in)

Cable glands: 1xM20 + 3xM16

Unit weight: 5.9kg (13lb) (WAS), 6.7kg (14.8lb) (WASPT)

Switch for liquid level (except for 11m version of WAS series)

Water tank capacity: 23l (6gal)

Delivery head: 11m (36ft) max

Tube length: 11m (36ft)

Supply voltage/Current consumption:

- 230Vac, 0.5A, 50/60Hz
- 120Vac, 1A, 50/60Hz
- 24Vac, 3.8A, 50/60Hz

Alarm outputs:

- Auto-powered: 1
- Dry contact: 1

Operating temperature

- Maximum temperature: 60°C (140°F)
- Minimum temperature with antifreeze liquid in solution: -10°C (14°F)
- Minimum temperature with antifreeze liquid in solution (reduced performance and delivery height): -25°C (-13°F)

Electrical safety (CE): EN60950-1

Electromagnetic compatibility (CE): EN50130-4, EN61000-6-3, EN55032, (Class B), FCC Part 15 (Class B)

Outdoor installation (CE): EN60950-22

IP protection degree (EN60529):

- IP66

EAC certification

Marine Certification: Lloyd's Register Marine Type Approval (only for the 11m version in the WASPT series)

Washer pump, tank of 23l (6gal), 30m (98ft) delivery

Polyethylene tank, stainless steel cage

Dimensions (WxHxL): 301x620x348mm (11.9x24.4x13.7in)

Cable glands: 1xM20 + 3xM16

Unit weight: 13.9kg (30.6lb) (WAS), 15.1kg (33.3lb) (WASPT)

Water tank capacity: 23l (6gal)

Delivery head: 30m (98ft) max

Tube length: 30m (98ft)

Switch for liquid level

Supply voltage/Current consumption:

- 230Vac, 2A, 50/60Hz
- 120Vac, 4.5A, 60Hz

Alarm outputs:

- Auto-powered: 1
- Dry contact: 1

Operating temperature

- Maximum temperature: 60°C (140°F)
- Minimum temperature with antifreeze liquid in solution: -10°C (14°F)

Electrical safety (CE): EN60950-1

Electromagnetic compatibility (CE): EN50130-4, EN61000-6-3, EN55032, (Class B), FCC Part 15 (Class B)

IP protection degree (EN60529):

- IPX4

EAC certification

DTWRX

Board for remote control of wiper and washer pump with WASPT

2 functions: WIPER, WASHER

31 selectable addresses through DIP switch

Serial input RS-485

2 status LED: Stand-by and receiver control

Dimensions: 43x56x13mm (1.7x2.2x0.51in)

Unit weight: 0.02kg

Power consumption: 0.5W

Half duplex RS-485 serial interface for keypad telemetry data reception (maximum distance 1200m/3940ft) and from SM matrix range (maximum distance 1200m/3940ft)

Protocols:

- PELCO D (2400, 9600 baud)
- VIDEOTEC MACRO (9600, 38400 baud)

For installation indoors and outdoors

Operating temperature: from -25°C up to +60°C

Electrical safety (CE): EN60950-1

Electromagnetic compatibility (CE): EN50130-4, EN61000-6-3, FCC Part 15 (Class B)

EAC certification

PART NUMBER

WASOV5L5M00	Water tank 5l (1 gal), pump with delivery up to 5m (16ft), IN 230Vac-24Vac-120Vac
WASOV23L5M00	Water tank 23l (6 gal), pump with delivery up to 5m (16ft), IN 230Vac-24Vac-120Vac
WASOV23L11M00	Water tank 23l (6 gal), pump with delivery up to 11m (36ft), IN 230Vac-24Vac-120Vac
WAS1V23L30M00	Water tank 23l (6 gal), pump with delivery up to 30m (98ft) with water floating, IN 230Vac
WAS3V23L30M00	Water tank 23l (6 gal), pump with delivery up to 30m (98ft) with water floating, IN 120Vac
WASPTOV5L5M00	Water tank 5l (1 gal), pump with delivery up to 5m (16ft), IN 230Vac-24Vac-120Vac
WASPTOV23L5M00	Water tank 23l (6 gal), pump with delivery up to 5m (16ft), IN 230Vac-24Vac-120Vac
WASPTOV23L11M00	Water tank 23l (6 gal), pump with delivery up to 11m (36ft) with water floating, IN 230Vac-24Vac-120Vac
WASPT1V23L30M00	Water tank 23l (6 gal), pump with delivery up to 30m (98ft) with water floating, IN 230Vac
WASPT3V23L30M00	Water tank 23l (6 gal), pump with delivery up to 30m (98ft) with water floating, IN 120Vac

ACCESSORIES

DTWRX	Data receiver for remote control of the wiper and WASPT range pumps in stand-alone housings
-------	---

PACKAGE

Model Number	Weight	Dimensions (WxHxL)	Master carton
WASOV5L5M00	4kg (8.8lb)	31x31x22cm	4
WASOV23L5M00	6.2kg (13.7lb)	32x37.5x51cm	-
WASOV23L11M00	5.9kg (13lb)	32x37.5x51cm	-
WAS1V23L30M00	13.1kg (28.9lb)	38x32x79cm (15x12.6x31.1in)	-
WASPTOV5L5M00	4.3kg	31x31x22cm	-
WASPTOV23L5M00	6.4kg (14lb)	32x37.5x51cm	-
WASPTOV23L11M00	7.5kg (16.5lb)	32x37.5x51cm	-
WASPT1V23L30M00	15.4kg	38x22x79cm	-

WASNX**MECHANICAL**

Enclosure made of stainless steel AISI 316L

Delivery pipe supplied

- Length: 20m (66ft)

Pressure: 4bar max

Delivery head: 20m (66ft)

Material (delivery pipe): Antistatic plastic

Dimensions (WxHxL): 429x697x255mm (16.9x27.4x10in)

Unit weight: 18kg (40lb)

Water tank capacity: 10l (2.6gal)

ELECTRICAL

Supply voltage/Current consumption

- 230Vac, 0.07A, 50/60Hz
- 120Vac, 0.13A, 50/60Hz
- 24Vac, 0.7A, 50/60Hz

ENVIRONMENT

For installation indoors and outdoors

Operating temperature of solenoid valve: from -20°C (-4°F) up to +60°C (140°F)

Operating temperature of device: depending on the solidification temperature of the liquid

CERTIFICATIONS

Electrical safety (CE): EN60950-1

Electromagnetic compatibility (CE): EN61000-6-2, EN61000-6-3

Outdoor installation (CE): EN60950-22

IP protection degree: EN60529, IP65 (solenoid valve only, enclosure not rated)

EAC certification

PART NUMBER

WASNX1V10L20M00 Tank 10l with integrated manual pump controlled by solenoid valve, delivery head up to 20m (66ft) max, IN 230Vac

WASNX2V10L20M00 Tank 10l with integrated manual pump controlled by solenoid valve, delivery head up to 20m (66ft) max, IN 24Vac

WASNX3V10L20M00 Tank 10l with integrated manual pump controlled by solenoid valve, delivery head up to 20m (66ft) max, IN 120Vac

SPARE PARTS

OWEXTANK Pump in stainless steel, 10l (2.6gal)

OWEXTUB Water pipe, 20m (66ft)

BRACKETS AND ADAPTORS

NXCOL AISI 316L stainless steel pole adapter module

NXCW AISI 316L stainless steel corner adapter module

PACKAGE

Model Number	Weight	Dimensions (WxHxL)	Master carton
WASNX1V10L20M00	20.3kg (44,7lb)	30x74x46cm (11.8x29.1x18.1in)	-
WASNX2V10L20M00	20.3kg (44,7lb)	30x74x46cm (11.8x29.1x18.1in)	-
WASNX3V10L20M00	20.3kg (44,7lb)	30x74x46cm (11.8x29.1x18.1in)	-

FM1010**ELECTRICAL**

Electrical data: from 0 up to 250V DC/AC 50/60 Hz, 6A

PART NUMBER

FM1010 EMC filter for Marine certification

TECHNICAL DRAWINGS

The dimensions of the drawings are in millimetres.

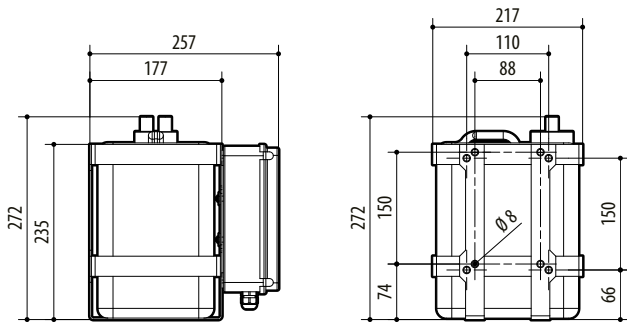

WATER TANK 5L (1.3GAL), 5M (16FT) DELIVERY (WAS-WASPT)

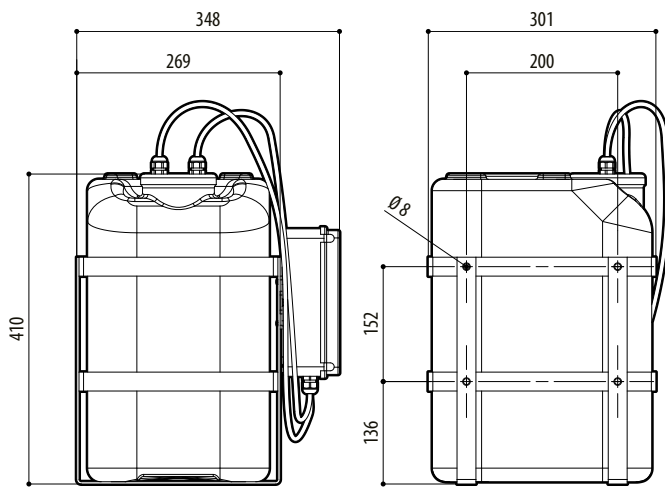

WATER TANK 23L (6GAL), 5M (16FT) DELIVERY (WAS-WASPT) O 11M (36FT) (WAS)

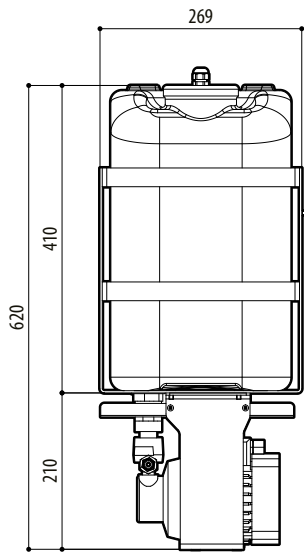

WATER TANK 23L (6GAL), 30M (98FT) DELIVERY (WAS)

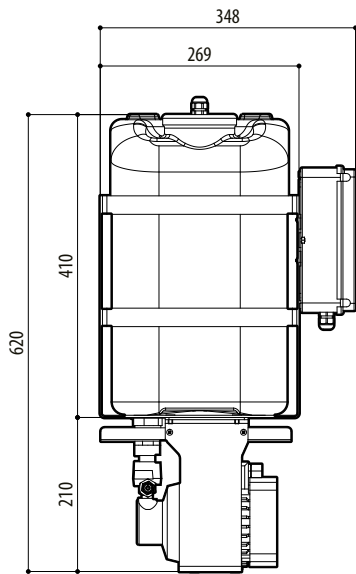
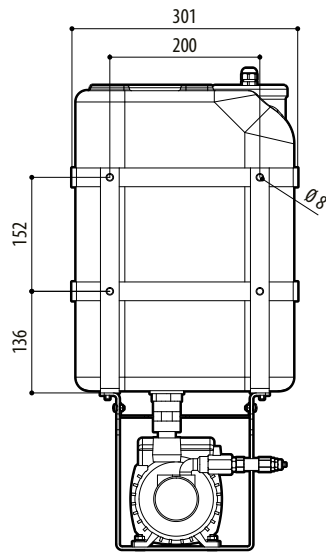

WATER TANK 23L (6GAL), 30M (98FT) DELIVERY (WASPT)

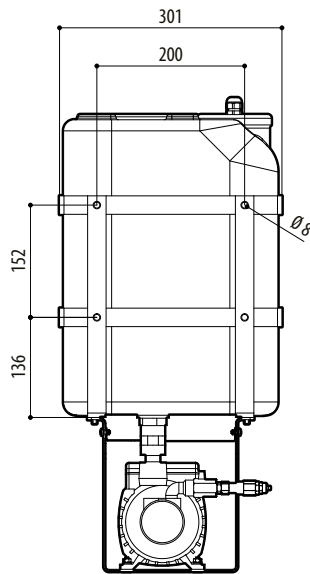

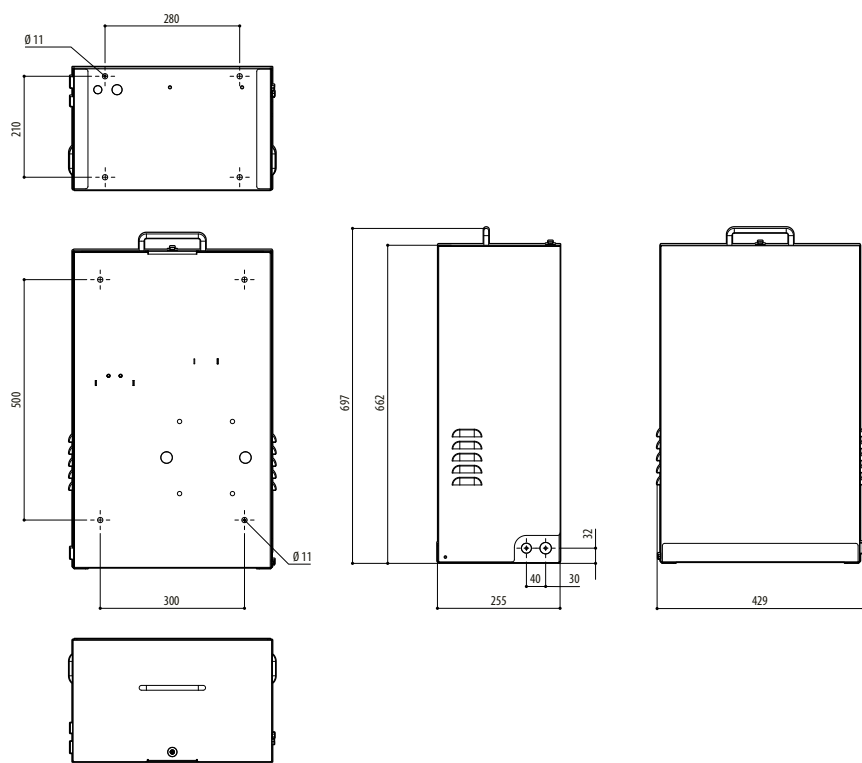

WASN