

NXFWBT

EXTENSION BRACKET FOR PARAPET MOUNTING



DESCRIPTION

Parapet mount for NXPTH P&T series constructed from AISI 316L thick gauge stainless steel. It can be coupled with the NXWBPTH1 wall bracket.

TECHNICAL DATA

MECHANICAL

Suitable for: MHXFWCA

Suitable to MVX housings only if coupled with MHXFWCA joint

Suitable for NXWBPTH1

Made of AISI 316L electropolished stainless steel

Load rating: 70kg (154lb)

Height: 124mm (4.9in)

Unit weight: 0.9kg (2lb)

PART NUMBER

NXFWBT AISI 316L stainless steel parapet mounting bracket

PACKAGE

Model Number	Weight	Dimensions (WxHxL)
NXFWBT	1kg (2.2lb)	10x16x23cm (4x6x9in) -

TECHNICAL DRAWINGS

The indicated measurements are expressed in millimetres.

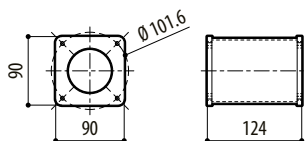

NXFWBT